

- NOTE:
1. ALL SIGNS AND MARKINGS SHALL CONFORM TO MUTCD
  2. ALL CROSS WALK STRIPING SHALL BE OUTSIDE THE WHEEL PATH.
  3. ALL REMOVALS SHALL BE BY HYDROBLASTING PROVIDED THAT THE PAVEMENT SURFACE SHALL NOT BE MATERIALLY DAMAGED. THE PAVEMENT MARKINGS SHALL BE REMOVED TO THE EXTENT THAT THE SHALL NOT BE VISIBLE UNDER DAY OR NIGHT CONDITIONS.

**EXISTING LEGEND**

	PROPERTY LINE
	R.O.W.
	LOT LINE
	EASEMENT LINE
	SECTION LINE
	ROAD CENTERLINE
	EDGE OF PAVEMENT
	CURB AND GUTTER
	CONCRETE
	FENCE
	RETAINING WALL
	WATER LINE
	RAW WATER LINE
	NON-POTABLE WATER LINE
	IRRIGATION LINE
	SANITARY SEWER
	STORM SEWER
	ELECTRIC LINE
	GAS LINE
	TELEPHONE LINE
	FIBER LINE
	OVERHEAD ELECTRIC LINE
	CABLE TELEVISION
	CONTOUR MAJOR
	CONTOUR MINOR

**PROPOSED LEGEND**

	PROPERTY LINE
	R.O.W.
	LOT LINE
	SETBACK
	EASEMENT
	ROAD CENTERLINE
	CURB AND GUTTER (CATCH)
	CURB AND GUTTER (SPILL)
	SIDEWALK

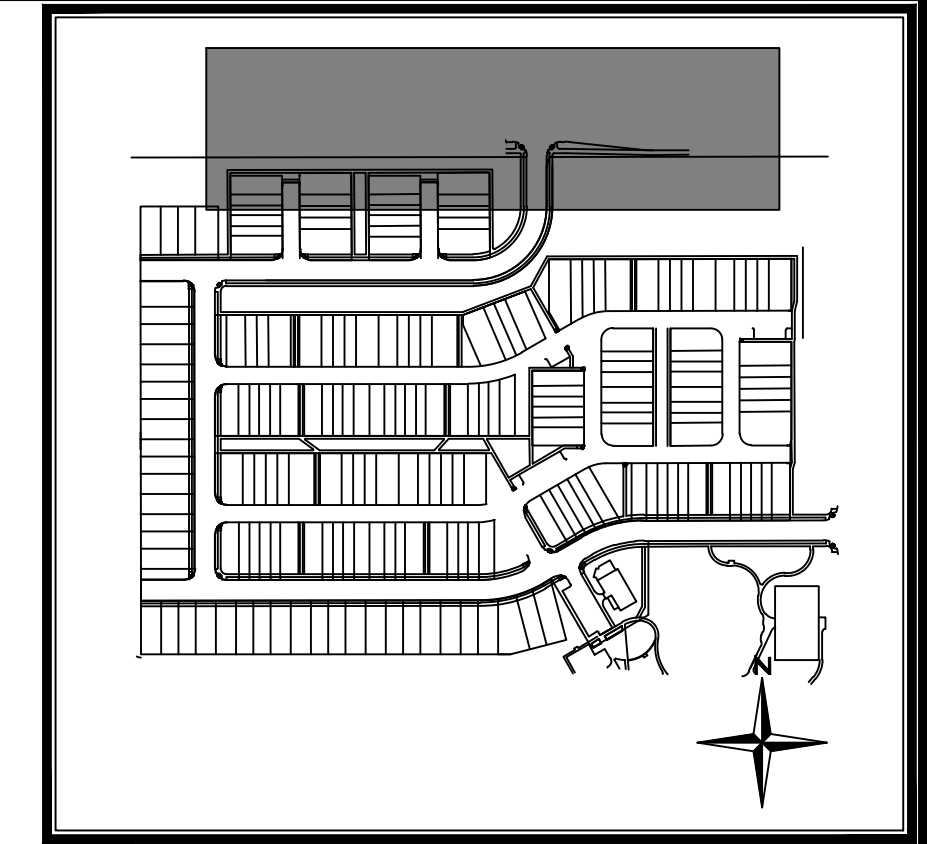
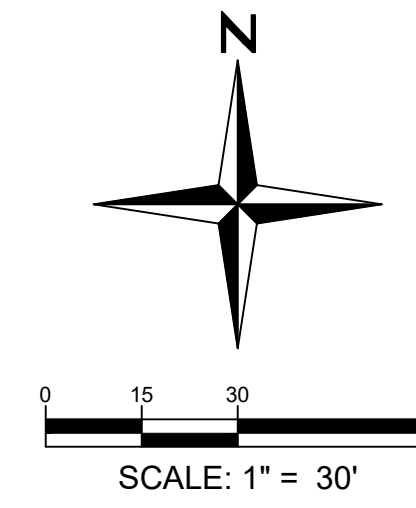

KEYMAP  
N.T.S.

**Redland**  
WHERE GREAT PLACES BEGIN  
700 283 4783 Office  
1500 West Canal Court  
Littleton, Colorado 80120  
REDLAND.COM

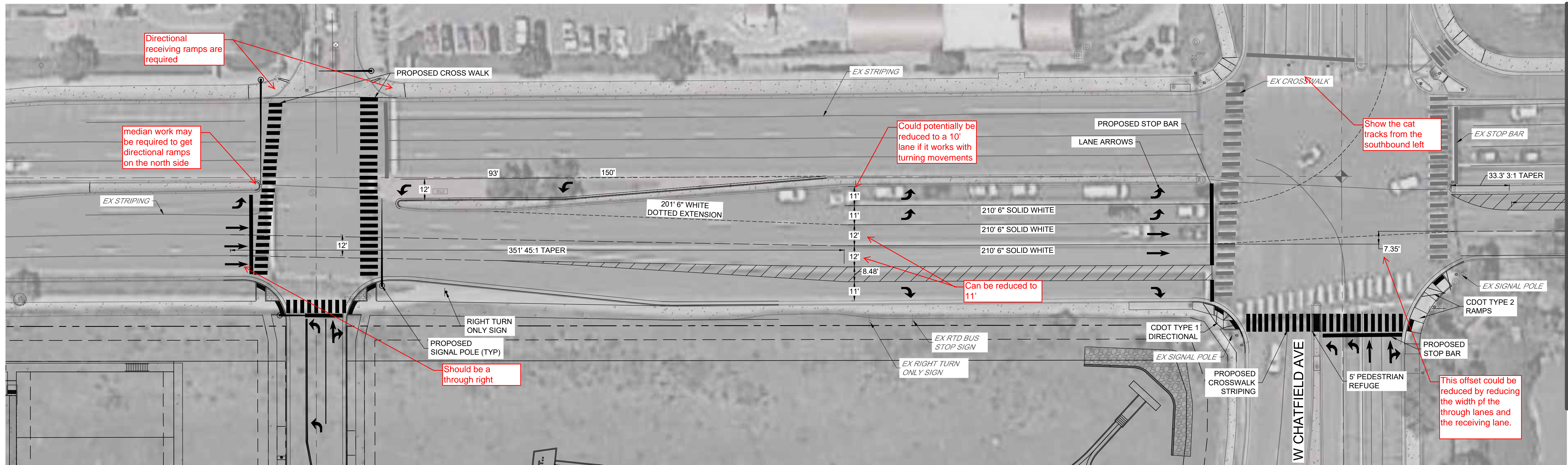

MATCHLINE  
SEE BELOW

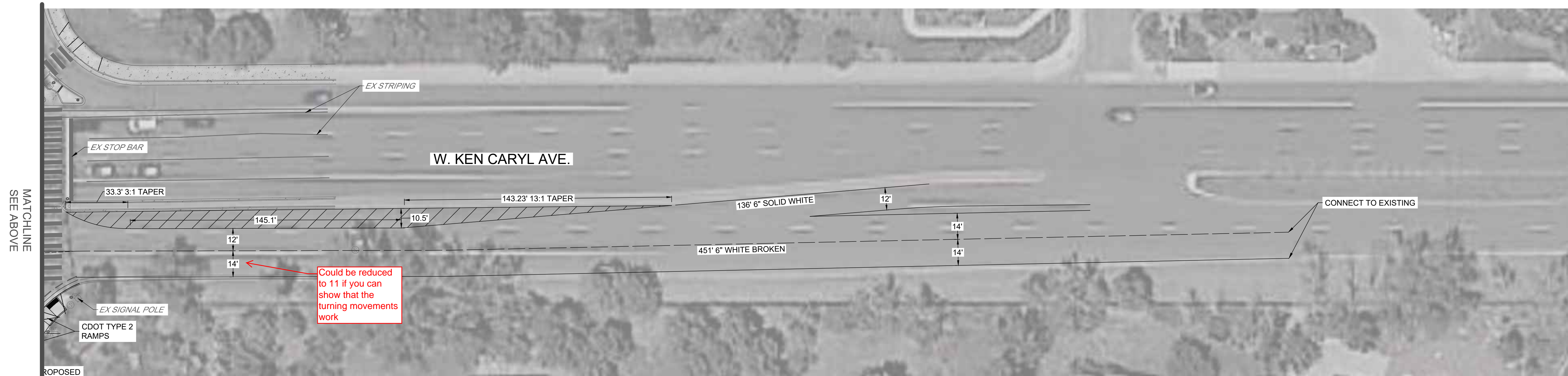

KEN CARYL RANCH NORTH PLAINS FILING 2

**KEN CARYL STRIPING**  
CONCEPTUAL PLAN

SHEET

C6.4

I:\2020\20001 - ken caryl ranch\CAD\sheet sets\c6.4 - 2001 - Signage and Striping Ken Caryl.dwg tab: C6.4 KEN CARYL STRIPING Feb 02, 2022 - 2:05pm ngesley